

# Installation Manual

FORD MUSTANG MACH-E 5DR  
FOR-MMAC-5-A



## Shades



Side Shades



Port Shades



Tailgate Shades

## Fixing Clips



CL-M13 x 4



CL-M02 x 4



CL-M01 x 2



CL-M14 x 1



# Installation

FORD MUSTANG MACH-E 5DR  
FOR-MMAC-5-A

## Components Needed



Side Shades



CL-M13 x 4



CL-M02 x 4

## Side Shade Installation

### STEP 1

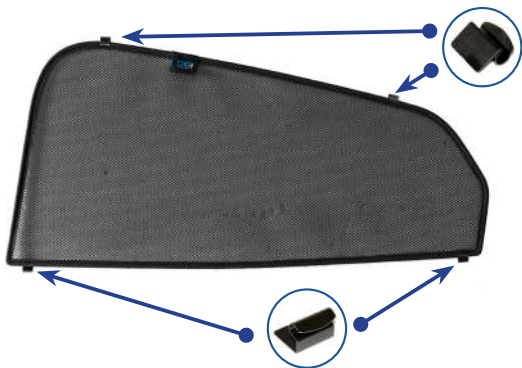

### STEP 2



Shade fits from the outside.

### STEP 3



### STEP 4



### STEP 5



### STEP 6



# Installation

FORD MUSTANG MACH-E 5DR  
FOR-MMAC-5-A



## Side Shade Installation

### STEP 7



*Ensure the clips fit between the seals*

### STEP 8



*Repeat this whole process for the other side.*

# Installation

FORD MUSTANG MACH-E 5DR  
FOR-MMAC-5-A

## Components Needed



Port Shades

## Port Shade Installation

### STEP 1



### STEP 2



### STEP 3



### STEP 4



### STEP 5



### STEP 6



Repeat this whole process for the other side.

# Installation

FORD MUSTANG MACH-E 5DR  
FOR-MMAC-5-A

## Components Needed



Tailgate Shades



CL-M01 x 2



CL-M14 x 1

## Tailgate Shade Installation

### STEP 1

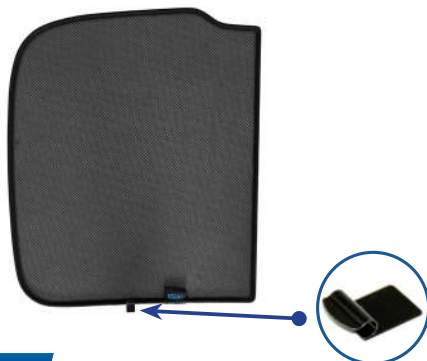

### STEP 2



### STEP 3



### STEP 4

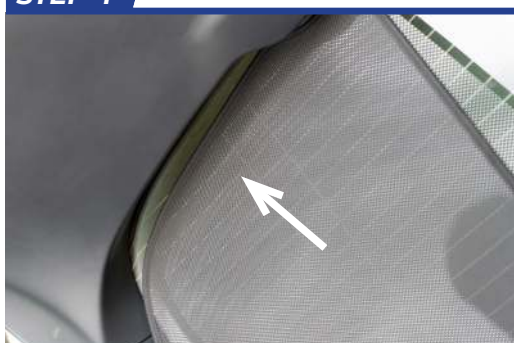

### STEP 5



### STEP 6

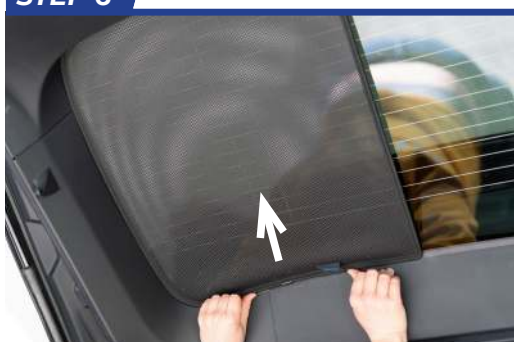



# Installation

FORD MUSTANG MACH-E 5DR  
FOR-MMAC-5-A



## Tailgate Shade Installation

### STEP 7



### STEP 8

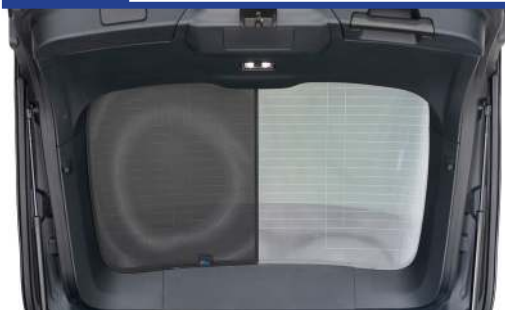

Repeat this whole process for the other side.

### STEP 9



### STEP 10



### STEP 11



### STEP 12

