

Installation Manual

BMW X1 5DR
BMW-X1-5-A-18



COMPONENTS INCLUDED



FIXING CLIPS



CL-M03 x 4



Side Shade Installation

BMW X1 5DR
BMW-X1-5-A-18

COMPONENTS NEEDED:



STEP #1

ATTACH CLIPS ON SHADE EDGES



STEP #2

POSITION THE SIDE SHADE



STEP #3

INSERT CLIPS INSIDE WEATHERSTRIP

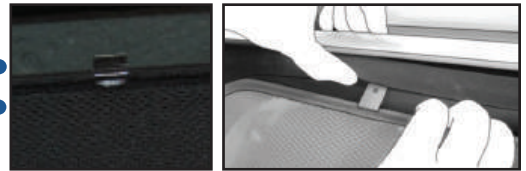

STEP #4

ENSURE SECURELY FITTED IN PLACE

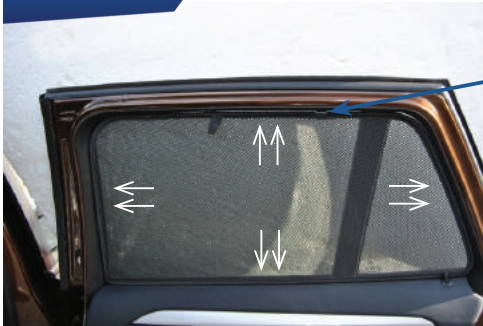

CAR
SHADES